



ATELIER DENSIDADES
GABINETE DE ARQUITECTURA,
ENGENHARIA E TÉCNICAS AFINS,
IMAGENS 3D, DESIGN E DESIGN DE MOBILIÁRIO

CENTRO EMPRESARIAL
E INDUSTRIAL DE LOULÉ
CAMPINA DE BAIXO, LOTE 1 - SALA 4
8100-285 LOULÉ

SITE VISITATION REPORT – August.2015

SITE VISITATION AND CLARIFICATION OF WORKS ACCORDING TO DETAIL PROJECT

t 00351 289 432 670
f 00351 289 432 671

info@densidades.pt
www.densidades.pt

Loulé, 31 August 2015

Site photos



Handled Issues:

1 Clarification regarding Lighting alcove detail
Solved, detail sent.

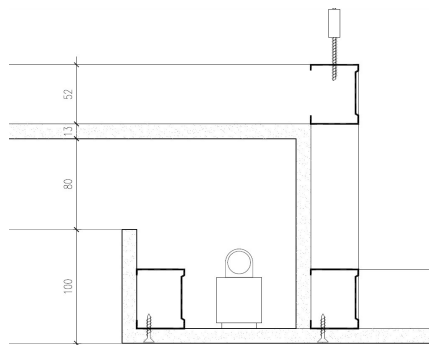

2 Alteration regarding stonework detailing of windows and doors to inset stones in walls 1.5cm to provide better adherence of stone to cement rendering and masonry (This is an alteration required by the builder to which we agree as it constitutes an improvement to the placing of stonework, however, as per our form of agreement DSM9-PPH-150406-042 is not included in the standard price, change to drawings took 4h x 35€/hour = 140€+VAT)

(continues)

DSM9-RAO-150831-005
RelatorioAcompObra
Aliceblue-08-2015



ATELIER DENSIDADES
GABINETE DE ARQUITECTURA,
ENGENHARIA E TÉCNICAS AFINS,
IMAGENS 3D, DESIGN E DESIGN DE MOBILIÁRIO

CENTRO EMPRESARIAL
E INDUSTRIAL DE LOULÉ
CAMPINA DE BAIXO, LOTE 1 - SALA 4
8100-285 LOULÉ

t 00351 289 432 670
f 00351 289 432 671

info@densidades.pt
www.densidades.pt

Loulé, 31 August 2015

3 Verification and clarification of structure of entrance where an error of marking points on site led to shortening of covered terrace by a meter. Lux will break and built to comply with the measure of the detail project without any costs involved for the clients.

4 Study of solution option for gutter of terraces surrounding swimming pools, asked by Lux, solution has been achieved by leveling terrace and use of hidden gutter element instead of grid gutter in the border of the terraces with the garden. Costs might be envolved.

5 Top Level of exterior patio near garage's enclosing walls seem a bit out of proportion (too big and high) regarding landscape, photo report and quick sketch will be presented to Arch.Richard and Clients to clarify, beginning of September

6 Definition of finishes of the house needed as soon as possible not to compromise deadlines and for due time order of materials to be on site.

7 Detail of glass railing around exterior swimming pool was presented however Lux has presented fit-in-floor solution which seems more adequate. Price will be checked.

PÁGINA 2 - 2